

ITEM 14. MOBILE CRANES – TEMPORARY ROAD CLOSURES – CLARE STREET SURRY HILLS

TRIM RECORD NO: 2017/426263

RECOMMENDATION

It is recommended that the Committee endorse the temporary road closure of Clare Street, Surry Hills, between Short and Hill Streets, on Wednesday 1 November 2017 from 8am to 12 noon, subject to the following conditions:

- (A) The Applicant must comply with the temporary road closure conditions as mentioned in Schedule B of this Agenda.
- (B) The Applicant must comply with any other conditions imposed by City's Construction Regulation Unit.
- (C) The Applicant has indicated Wednesday 8 November 2017 as an alternative date in case of inclement weather.
- (D) The Applicant must contact Surry Hills Police to obtain a separate police permit and to discuss deployment of user pay police for the road closure.
- (E) The Applicant must provide a telephone number of the supervisor responsible for the proposed closure and include contact details in the notification letters to be distributed to affected stakeholders.

VOTING MEMBERS FOR THIS ITEM

<i>Voting Members</i>	<i>Support</i>	<i>Object</i>
City of Sydney		
Roads and Maritime Services		
NSW Police – Surry Hills LAC		
Representative for the Member for Sydney		

DECISION

BACKGROUND

Botany Cranes has applied for the temporary road closure of Clare Street, Surry Hills, between Short and Hill Streets, on Wednesday 1 November 2017 from 8am to 12 noon.

COMMENTS

The proposed temporary road closure is required to allow a mobile crane to hoist air conditioning units onto the roof of 2 Short Street, Surry Hills.

The Applicant has provided a site-specific Traffic Control Plan that includes details of barricades, signs, flagmen and other traffic devices to implement the proposed road closure.

There are currently no other approved temporary road closures proposed to take place on the same day in close proximity of this closure.

The temporary road closure will not affect any other properties, as local access will be provided at all times and alternative access routes are available nearby.

A Traffic Management Plan (TMP) for the temporary road closure was approved by Roads and Maritime Services (RMS).

CONSULTATION

The Applicant will be required to notify affected stakeholders as stipulated in Schedule B.

FINANCIAL

All costs associated with the proposed closure will be borne by the Applicant.

ATTACHMENTS

Mobile Cranes – Temporary Road Closures – Clare Street, Surry Hills

Claudia Calabro, Traffic Works Coordinator



Date: 24/08/2017 **Author:** Liam Sweeten **Project:** Botany Cranes - 2 Short Street, Surry Hills www.invarion.com
Prepare a Work Zone Traffic Management Plan Licence: 0031116409 **Scale:** Not drawn to scale

Comments:

Temporary Full Road Closure of Claire Street, Surry Hills
 Temporary detour will be in place to maintain local traffic.
 Residential access will be provided under Authorised Traffic Control.



This TCP has been drawn to AS1742.3. The TCP must be implemented by qualified person/s. This TCP may be altered by an RMS accredited person/s holding a valid PREPARE A WORK ZONE TRAFFIC MANAGEMENT PLAN qualification. SSTC does not endorse the use of this plan by anyone unless implemented by a qualified person/s.

SSTC DOES NOT ACCEPT LIABILITY FOR ANY USE OF THE TCP UNLESS IMPLEMENT DIRECTLY BY AN AUTHORIZED REPRESENTATIVE OF SSTC HOLDING VALID QUALIFICATIONS TO CARRY OUT SUCH WORKS.

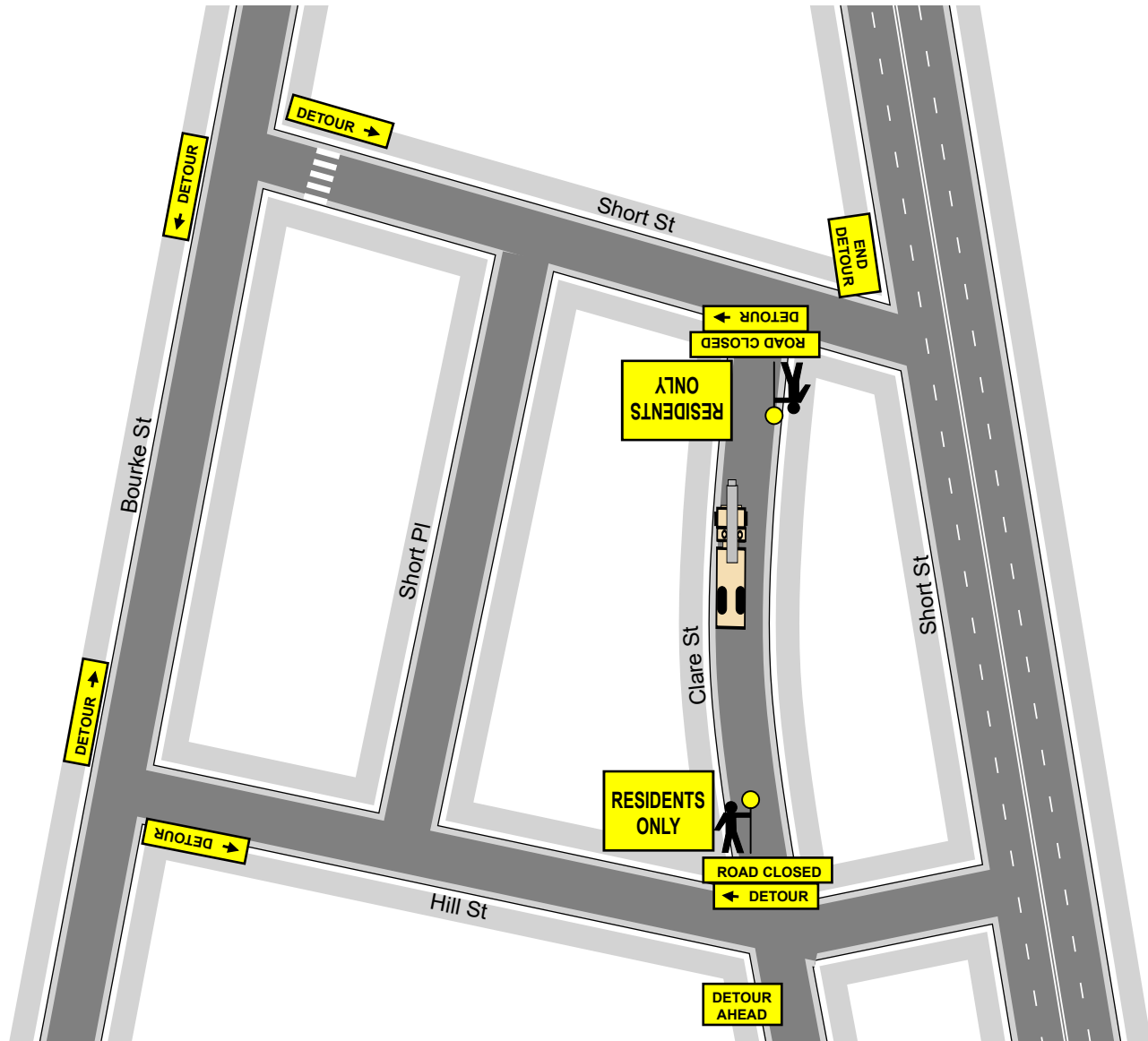

All sign spacing and taper lengths are in accordance Australian Standards AS 1742.3. distances between signs may vary due to on site constraints i.e. parked vehicles / vegetation etc. (plan not to scale)
 Traffic controllers are to conduct slow/stop procedures to assist with work vehicle movements
 Traffic controllers are to assist pedestrians around work area as required.
 Pedestrian signs to be installed as required.

Dm (Speed Limit)	Merge taper length	Lateral taper length	Buffer length
45 or less	15	15	30
46 to 55	30	15	30
56 to 65	60	30	30
66 to 75	115	70	30
76 to 85	130	80	40
86 to 95	145	90	40
96 to 105	160	100	50
Greater than 105	180	110	50

Based on AS 1742.3-2009

← PEDESTRIANS

PEDESTRIANS →

PEDESTRIANS WATCH YOUR STEP

FOOTPATH CLOSED

LOOK BOTH WAYS
↔
TWO-WAY TRAFFIC

NO PEDESTRIAN ACCESS

